



SOMATRATADO

The SOMA TRATADO panel is a WBP plywood, produced with natural resources and wood from forest management and/or reforestation.

High durability
multilaminated plywood treated in an autoclave plant



INDICATED FOR FLOORS AND COVERINGS FOR BUSES, TRAINS, SUBWAYS, MOTOR – HOME, AMONG OTHERS. USED AS WALLS, LININGS, FLOORS IN THE HOUSE AND BASE FOR SHINGLE ROOFS.

SOMATRATADO		
CUSTOM MEASURES ACCORDING TO THE CUSTOMER'S NEEDS. MAXIMUM WIDTH 2500MM AND MAXIMUM LENGTH 9000MM.		
STANDART MEASURES		
Length (mm)	Width (mm)	THICKNESSES
2500 – 2440	1220	12,14 e 18
	1600	

* Other measurements and thicknesses on request

TOLERANCE TABLE ACCORDING TO NBR 1954			
THICKNESS/quantity of sheets	THICKNESS VARIATION	SQUARE	DIMENSIONAL
12MM – 7L	± 0,8mm	± 2,0mm	± 2,0mm
14MM – 7L	± 1,0mm	± 2,0mm	± 2,0mm
18 MM – 9L	± 1,0mm	± 2,0mm	± 2,0mm

PRODUCT COMPOSITION

GLUE

Meets the bond strength requirements as set out in the EN 314 standard. The wood veneers are bonded with WBP phenolic resin, 100% waterproof.

CARB CERTIFIED PRODUCT 2. LOW FORMOLDEHYDE EMISSION.

EDGES

The edges of SOMA BUS are sealed with ink to prevent/delay the absorption of moisture, ensure a perfect seal, delaying the phenomenon of swelling and contraction. **NBR 9486**

FACE AND BACK

Coming from forest management or reforestation areas.

TREATMENT

Treatment against wood biodegradation: performed in an autoclave plant with retention of active ingredients greater than 6.5 kg/m³. The preservative used is CCA with 72% of the active ingredients.

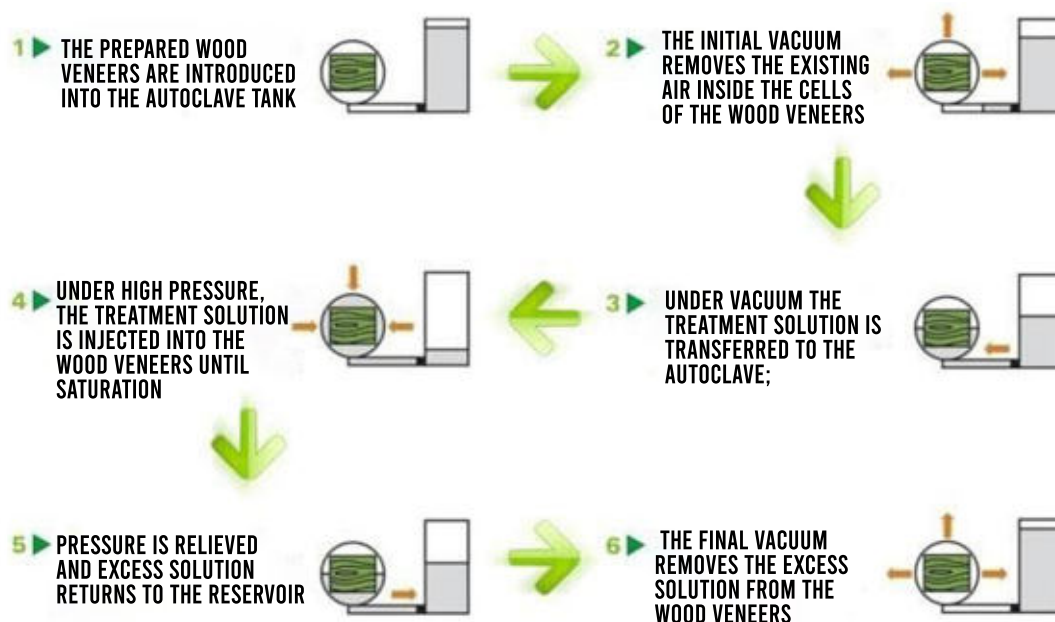

SURFACE FINISH	COATING	HUE
Calibrated/SANDED	uncoated	slightly greenish wood finish

MACHINING AND MECHANIZATION

It is possible, on request, to make holes, cutouts, rounding of the tops. Lowering, tongue-and-groove (T&G), joint with BizeL, among others.

ADVANTAGES AND BENEFITS



PROVIDE SIGNIFICANT SAVINGS
IN VIEW OF THE HIGH DURABILITY
AND STABILITY OF THE PRODUCT



THE IMPREGNATED PRESERVATIVE DOES NOT
SIGNIFICANTLY CHANGE THE PHYSICAL
AND MECHANICAL PROPERTIES OF THE PRODUCT



HIGH DURABILITY WHEN EXPOSED
TO EXTREME WEATHER CONDITIONS OR IN
CONDITIONS CONDUCTIVE TO
WOOD BIODEGRADATION



SPECIFIC AGAINST THE ATTACK OF
XYLOPHAGOUS TERMITES



MAXIMUM RESISTANCE DUE
TO THE STRUCTURAL COMPOSITION OF
THE PANELS, ALTERNATING BLADES IN
PARALLEL AND PERPENDICULAR DIRECTIONS

GUARANTEES

The Somapar plywood panel is guaranteed for one year (12 months) against production defects, as long as the instructions for use are followed. See the technical proposal.

TRACEABILITY

Through the production batch number and or the manufacturing date, it is possible to trace all production processes, the origin of inputs and raw materials that make up the product.

PACKAGING, TRANSPORTATION AND STORAGE

Pieces packed in a palatized way and belted with steel ribbons.



CONTACT US

www.somapar.com.br

Rod. BR 476 Km 363,40 nº 1238 – Bairro São Joaquim
União da Vitória-PR, Brasil | CEP 84.605-250

contato@somapar.com.br

+55 (42) 3521-2900 | +55 (42) 9 9990-0206

/SOMAPAR

somapar_mad

